

upCast RT Licensing Scenario Overview

This document shows exemplary scenarios in which upCast RT is typically used. It is meant to help you identify your specific usage scenario of upCast RT, which is needed to offer you a suitable license.

If you do not find yourself in any of the following scenarios, please do not hesitate to [contact us](#).

Terms and Pictograms used in this document



Author

An author is the person who **authors** the content that will be processed by upCast RT. Note that this is usually not identical with the corrector or editor of the content.



Content Handler

A content handler is a person who handles, i.e. collects, edits or corrects and processes content that one or several authors have created. Editors or service providers usually act as a content handler.



Workstation

A workstation is the computer a user has upCast RT locally installed on and whereon she initiates and runs single conversions manually.



Server

A server is a computer where upCast RT is deployed on. It typically processes documents in an automatic manner not requiring human interaction (using upCast RT Java or commandline APIs to implement automation, scripting or hot folder concepts), and often are accessed through a network connection. Servers can vary in CPU processing power, CPU count, available memory or network connections and therefore in the number of instances they can run upCast RT instances concurrently in a reasonable number.



Company

This bounding rectangle symbolizes the physical and logical borders of a single company.

Licensee

A license is made out to a **licensee**, who always is the **end user/contracting company** for the processing done with upCast RT. It is *not* a possibly external service provider who performs the processing by order and for account of the end user/contracting body.

This means among other things that the end user/contracting company must be properly licensed for upCast RT before it can be used by its service provider to process content using its functionality – regardless on whose CPUs the processing actually takes place.

Scenario 1: Single Author

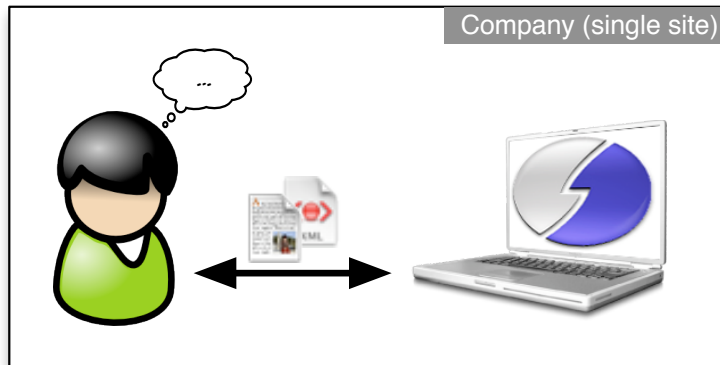

This licensing scenario is used when a single named author (who needs to be licensed) is identical with the person that performs the function of the content handler. The person obtaining the Single Author license for a single computer uses it only to manually initiate the processing of content he exclusively authors and he is the originator of.

Scenario 2: Server

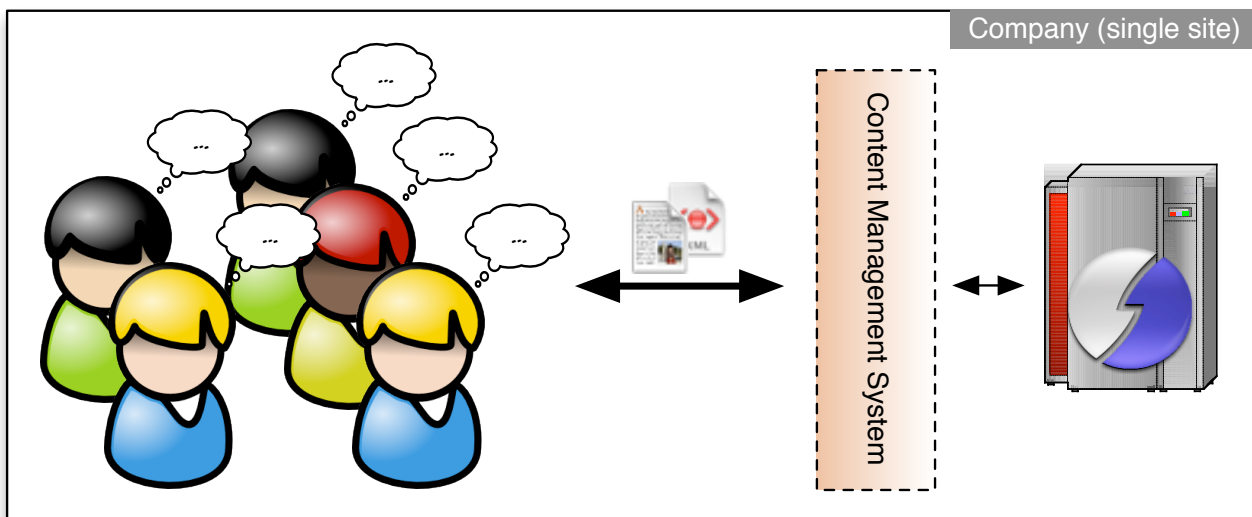

In this scenario, the content of a certain number of authors (who need to be licensed) is being processed by upCast RT within a company-internal system. The embedding of upCast RT in that system can be implemented using the upCast RT Java API, its commandline interface using batch files or scripts, a hot-folder concept or any other means of access. In this scenario, upCast RT typically runs on one or several CPUs (that need to be licensed) that authors can access directly or indirectly, e.g. via a content management system layer or an other intranet application.

This license can be any of the following common license types:

- department license
- project license
- site license
- company license

Scenario 3: Aggregators (internal)

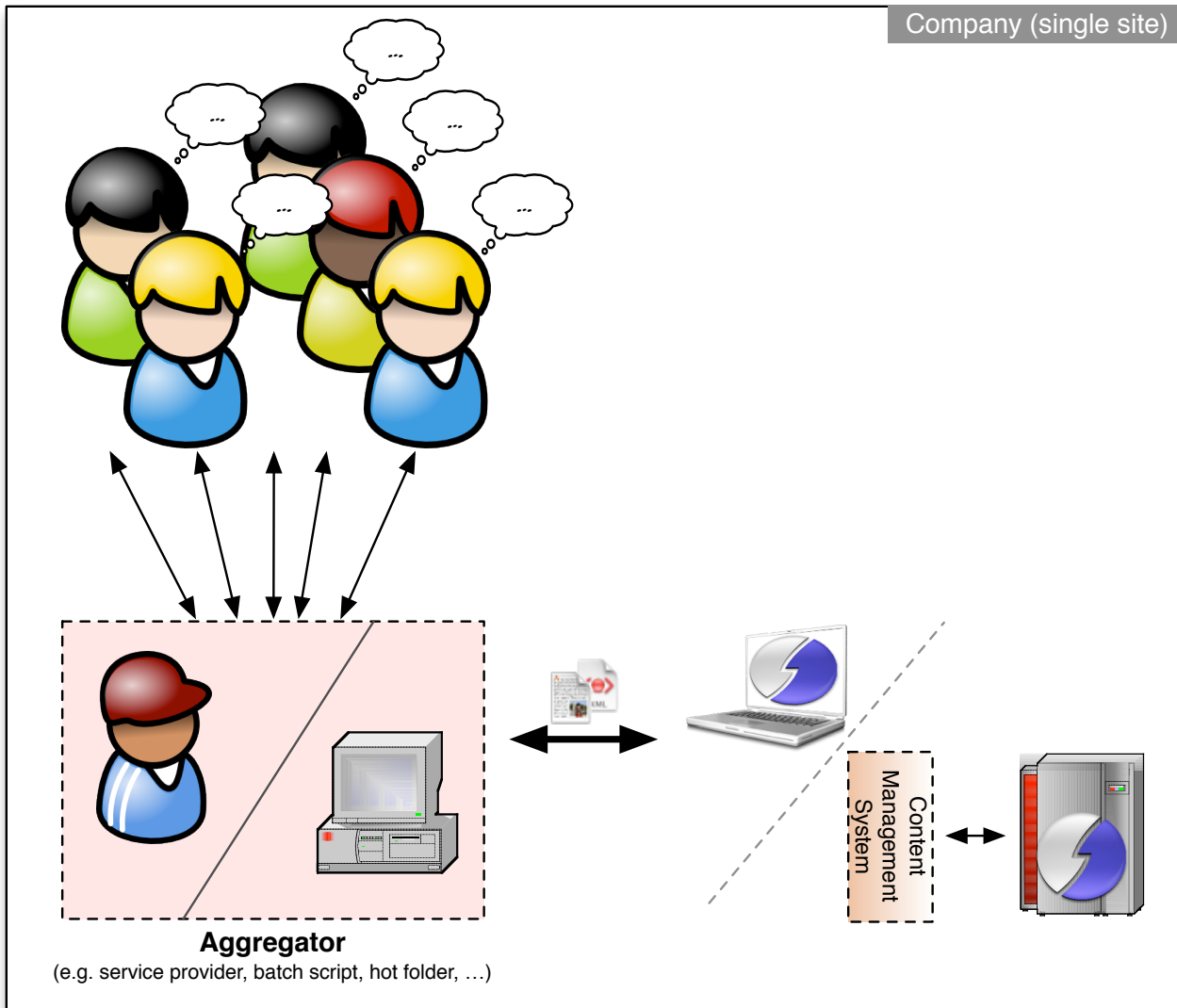

An aggregator is either a content handler (a human), or some device or program (application, script, hot folder, etc.) that performs tasks that a content handler does .
In upCast RT licensing and metrics, aggregators are irrelevant and considered non-existent with regard to licensing metrics. This scenario therefore is essentially identical to Scenario 2 above, with the authors thought to being connected directly to the system applying upCast RT processing to the content they produce.

Scenario 4: Service providers

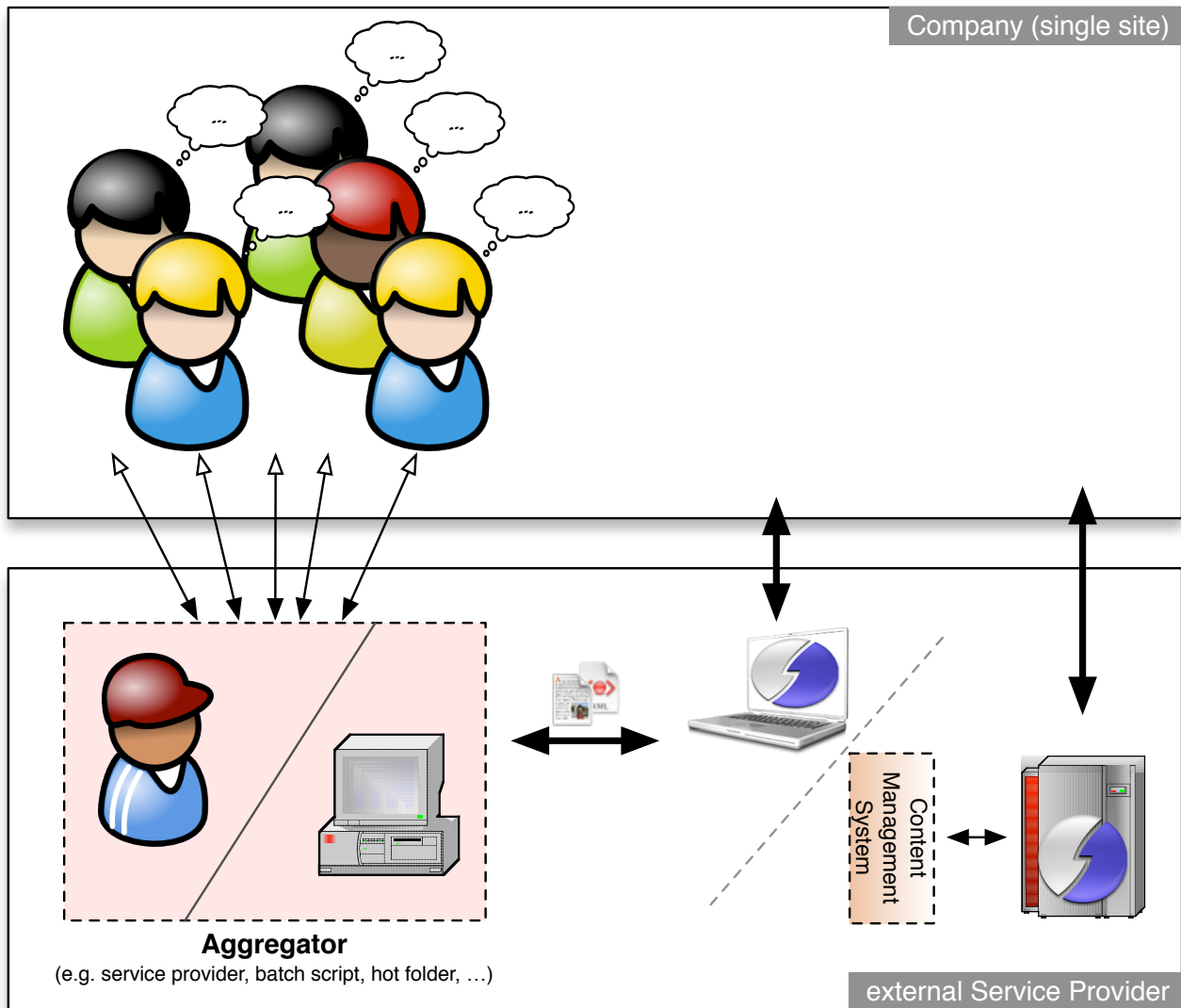

An external service provider utilizing upCast RT functionality can be thought of an external aggregator (see Scenario 3). As such, it is irrelevant concerning upCast RT licensing and metrics. Instead, the scenario can be reduced to the case of Scenario 2. Since upCast RT is licensed to the end user/contracting company, it must license upCast RT according to Scenario 2 and then make that license available to its contractor as necessary. The licensee must make sure that the license is used by his service provider(s) in compliance with the upCast RT License Agreement.